



## IT INDICE

1. FERRAMENTA .....	1
2. INSTALLAZIONE .....	2

## GB CONTENTS

1. HARDWARE KIT .....	1
2. INSTALLATION .....	2





## D INHALTSVERZEICHNIS

1. EISENWAREN-KIT .....	1
2. MONTAGE .....	2

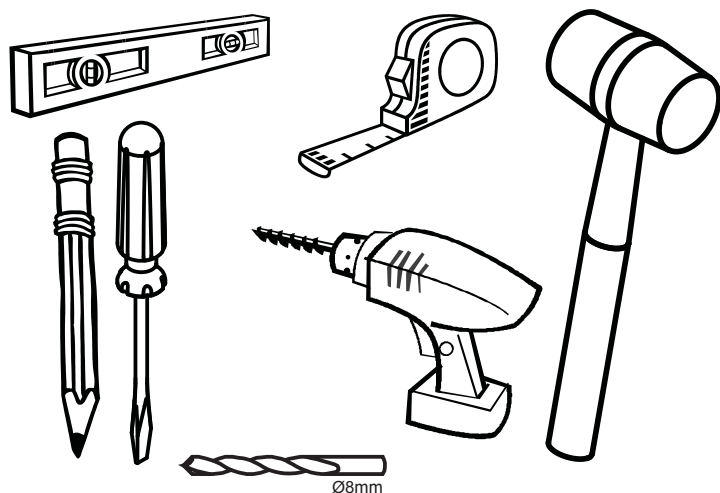
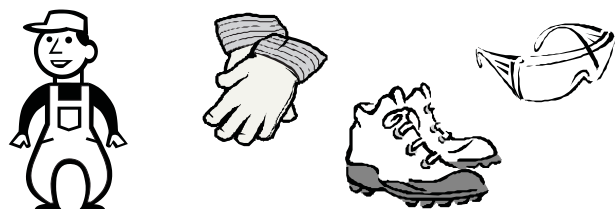
## F INDEX

1. QUINCAILLERIE .....	1
2. INSTALLATION .....	2



- IT** ATTENZIONE:  
 - Verificare la condizione del supporto prima di installare la specchiera e scegliere viti adeguate al supporto esistente. 
- GB** ATTENTION:  
 - Check the support condition before proceeding with the installation of the mirror; also choose adequate screw for the existing support. 
- D** ACHTUNG:  
 - Vor der installation des spiegels den zustand des halters prüfen; wählen sie angemessene schrauben für bestehenden halter aus. 
- F** ATTENZIONE:  
 - Vérifier les conditions du support avant d'installer le miroir et choisir les vis adéquates au support existant. 

**IT FERRAMENTA**      **GB HARDWARE KIT**  
**D EISENWAREN-KIT**      **F QUINCAILLERIE**

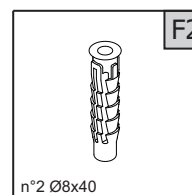
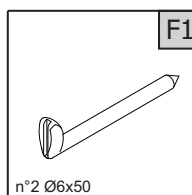

01

- IT Le misure sono espresse in cm. Tra parentesi le quote consigliate
- GB All measurements are in centimetres. In brackets the suggested measures.
- D Abmessungen in Zentimeters (cm). In Klammern die empfohlene vermessungen.
- F Les mesures sont en cm. Entre parenthèses les cotes conseillées.

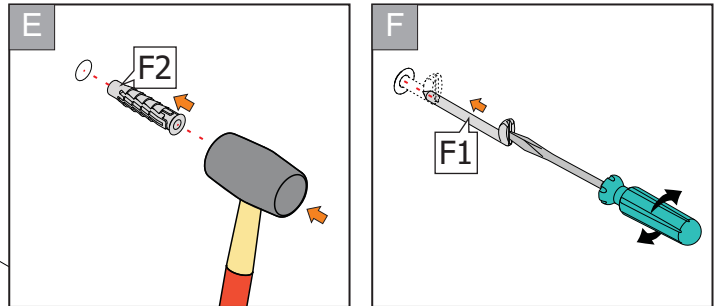
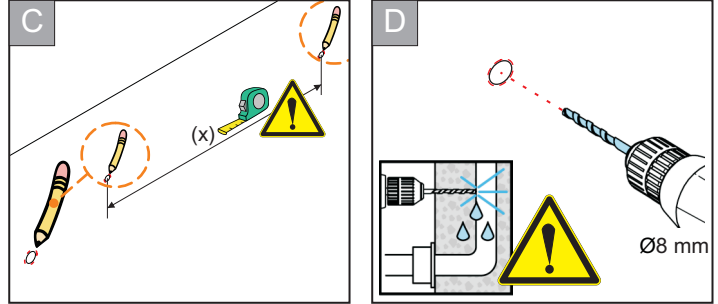
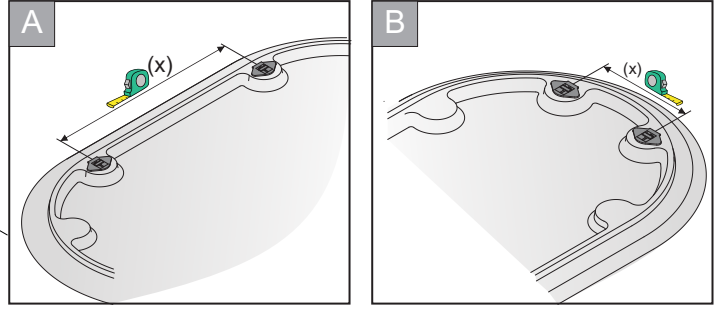
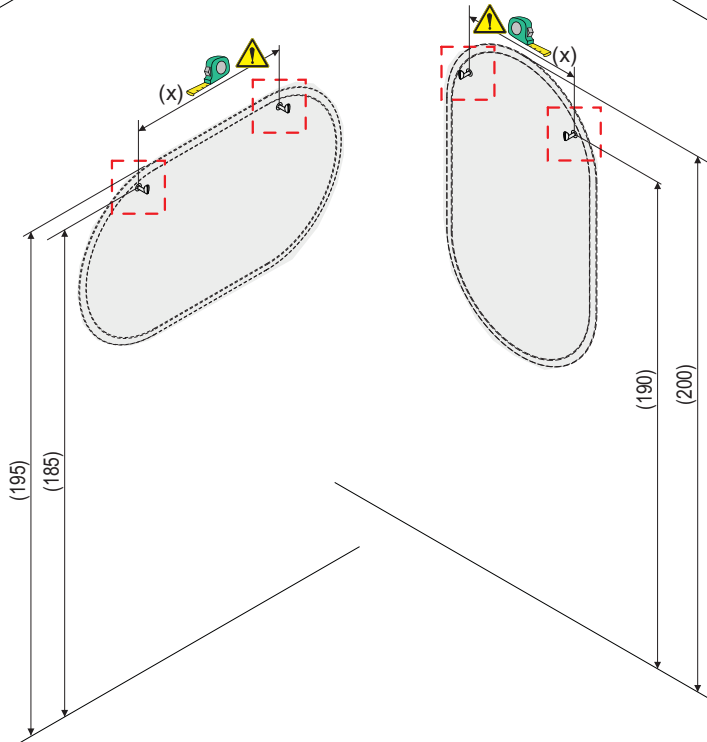

02

